

SETUP1

Install the base then slide the vertical pole sections onto the foot as shown.

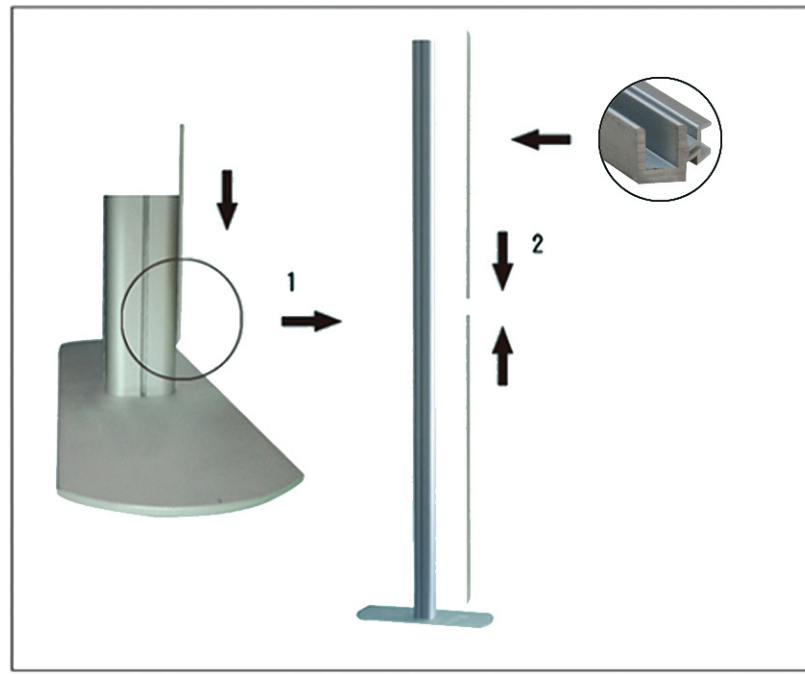

SETUP2

Assemble the aluminum profile which can inlay printing.

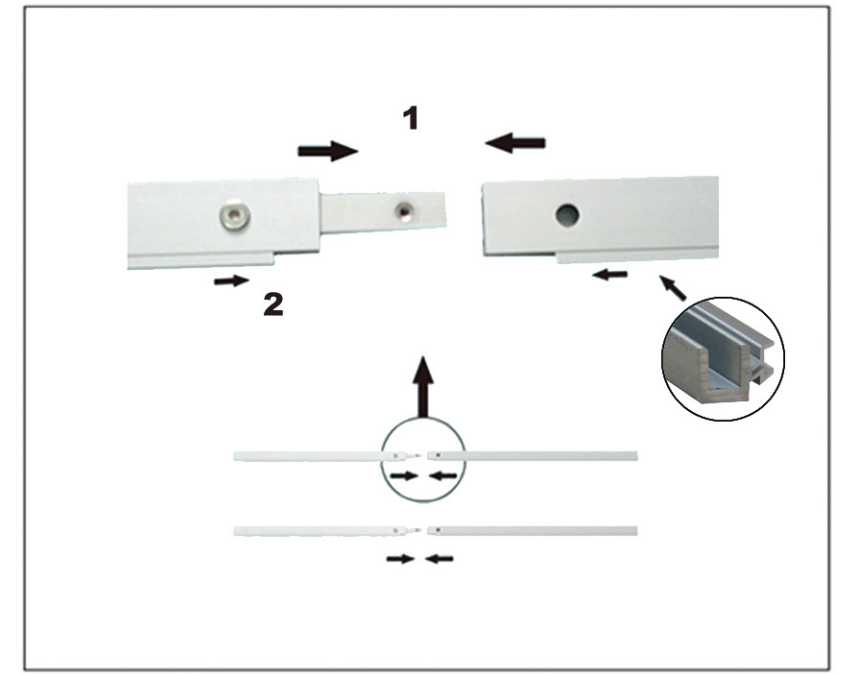

SETUP3

Connect the rails.

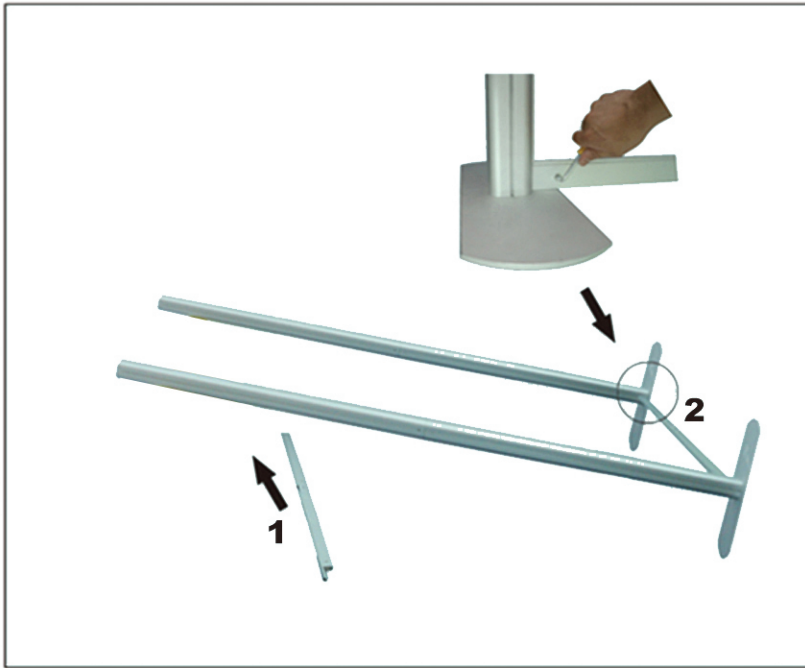

SETUP4

Connect the top and bottom rail using screw.

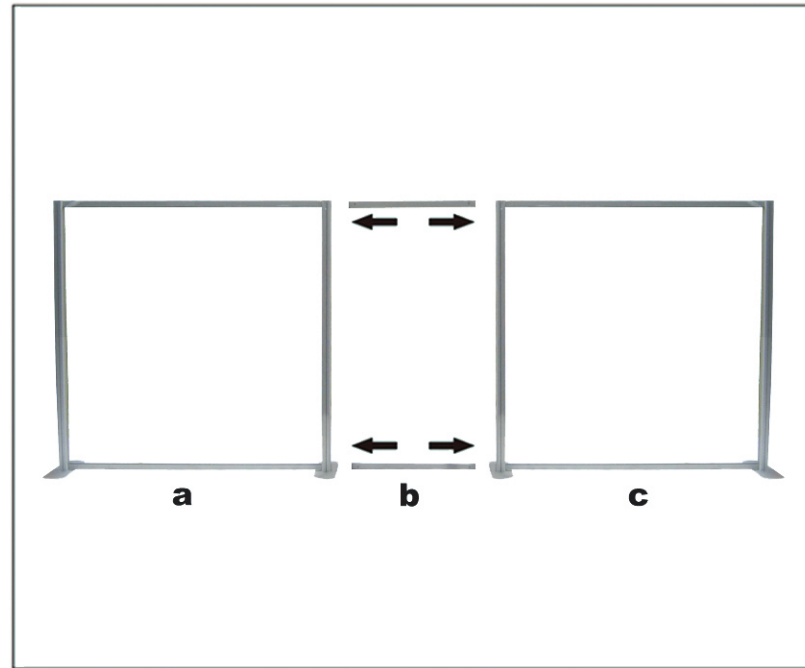

SETUP5

Finish the main profiles.

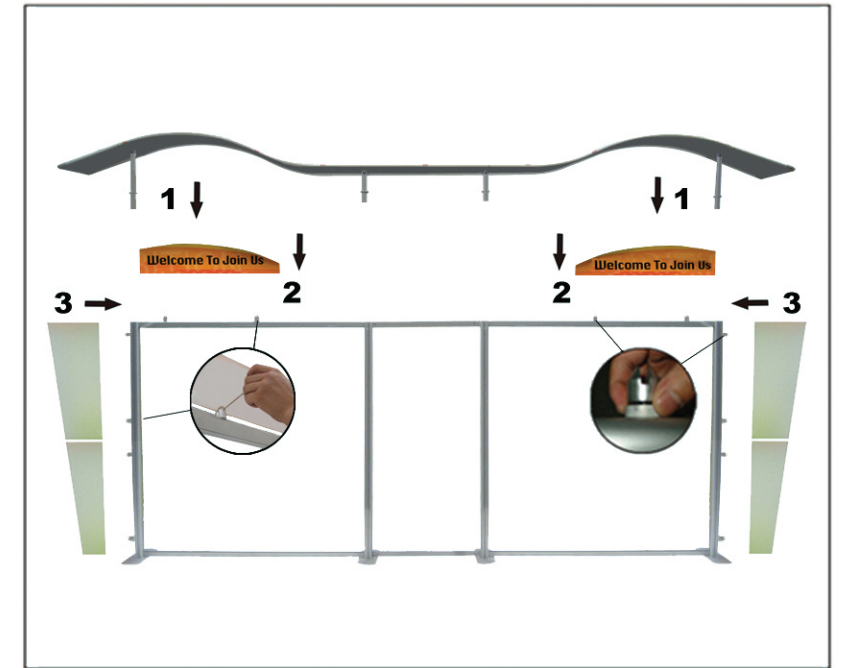

SETUP7

Connect roof profiles and side profiles.

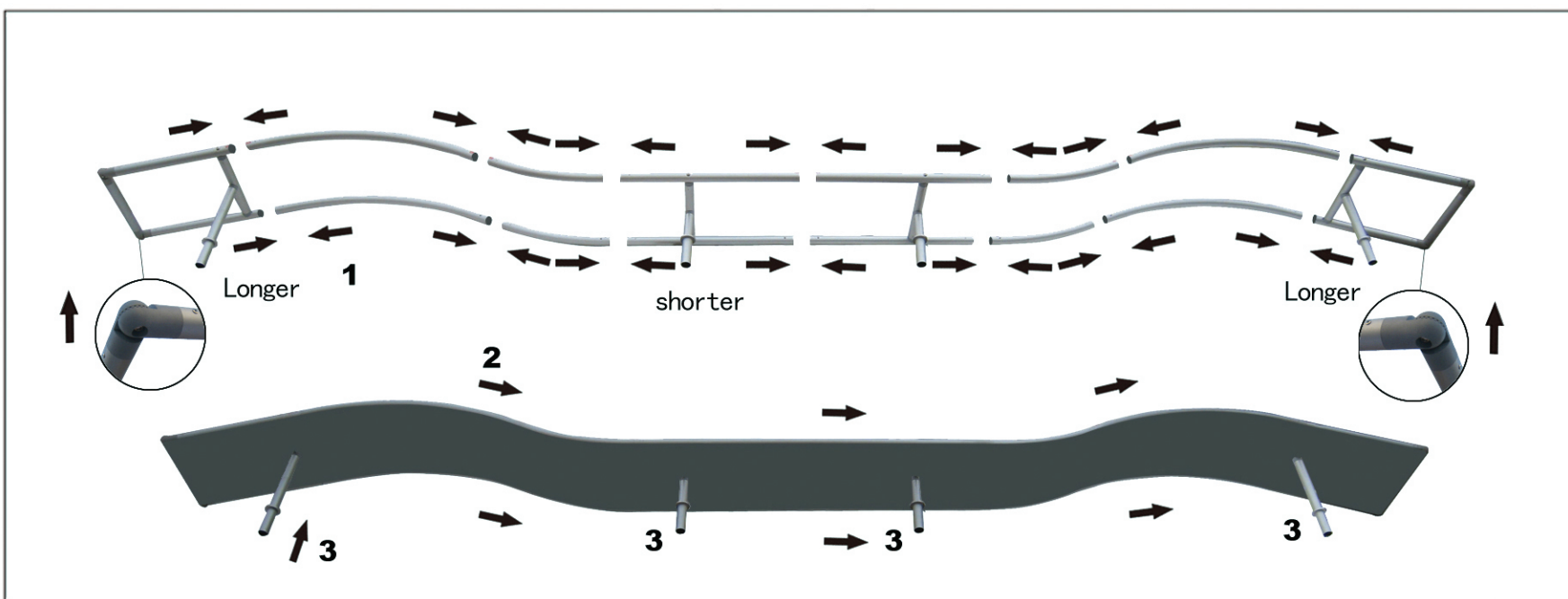

SETUP6

Install the roof printing and supporting profile.

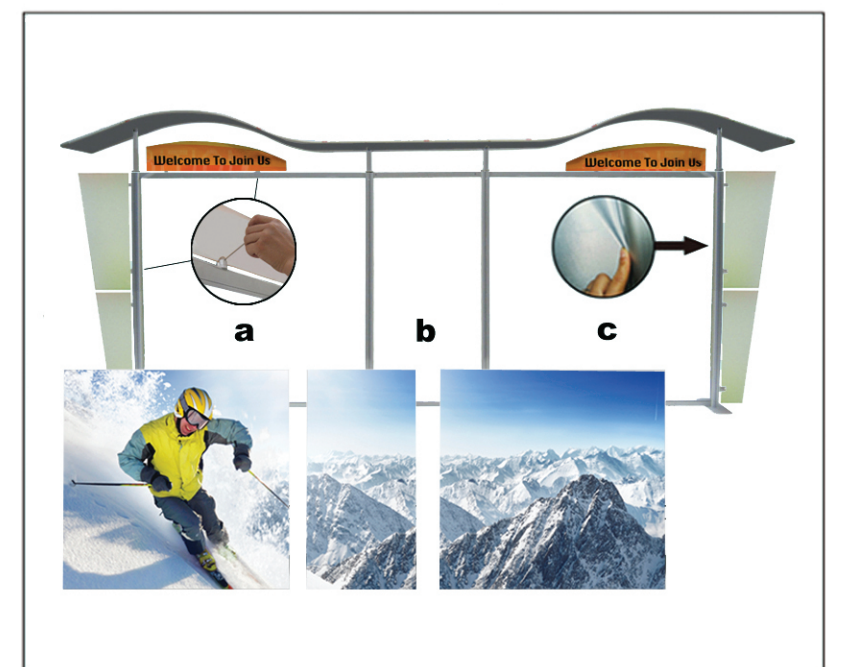

SETUP8

Install printing.



SETUP9

Insert the "T" shaped screws and put on the nut. Push the "T" into the profile making sure the "T" screw is in the locking position.



SETUP10

Install the Lamp.
Install the table shelf.
Install the counter, table & LED (optional)

